

EVANS & ASSOCIATES CONSTRUCTION CO., INC.

3320 NORTH 4TH STREET, PONCA CITY, OKLAHOMA 74602

MINE NAME **BIG FORK RANCH**

R 3 E

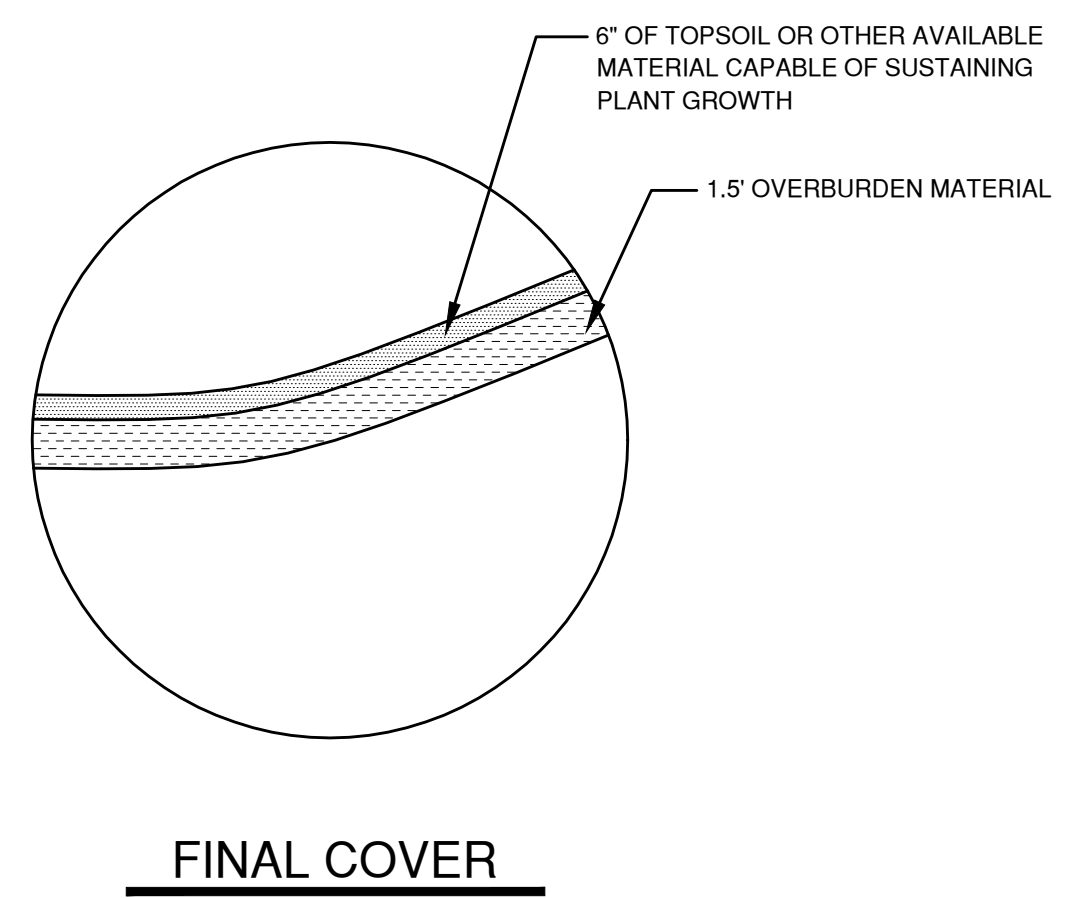
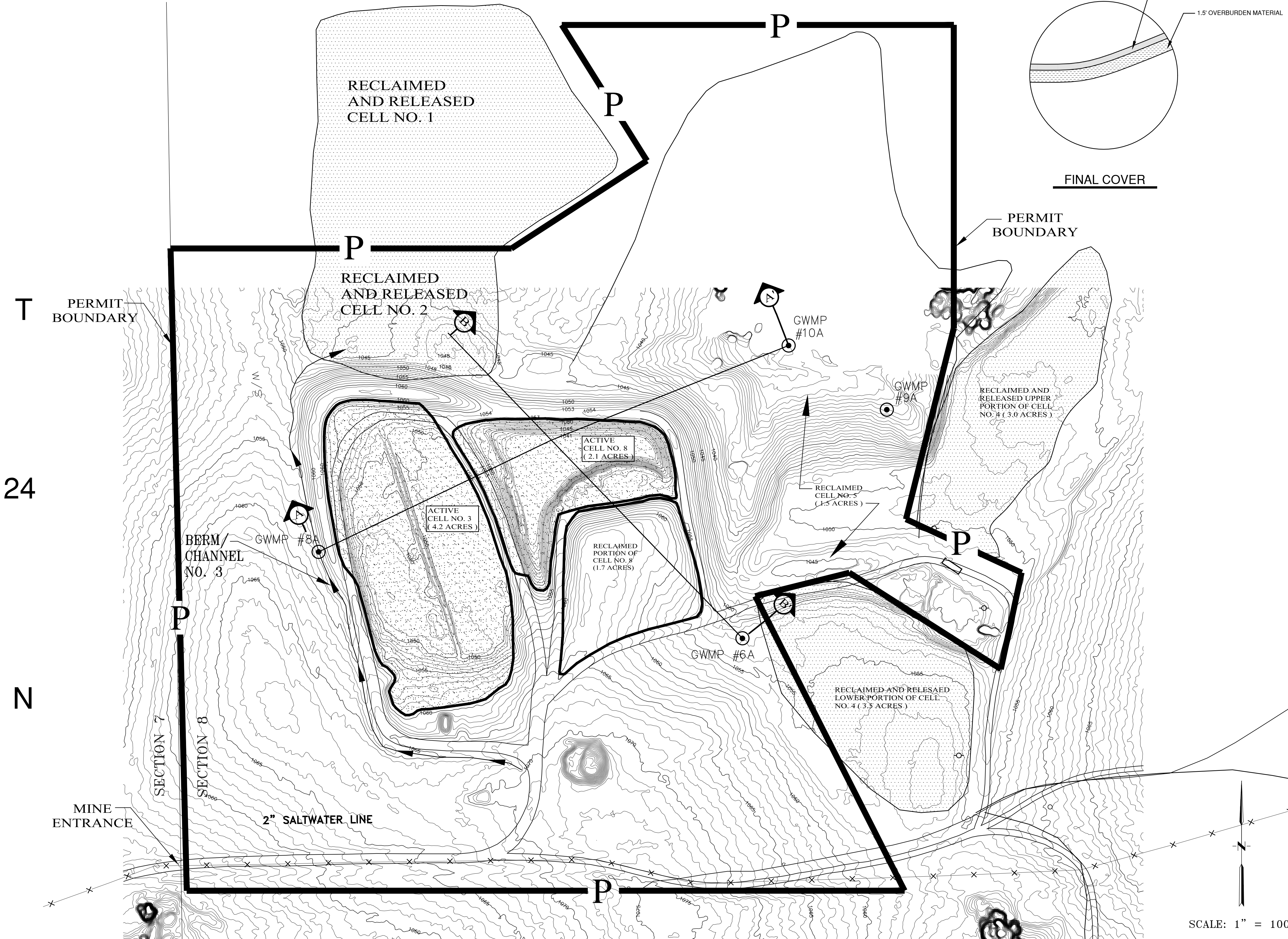

LEGEND	
PROPERTY BOUNDARIES
PERMIT BOUNDARIES P
SURFACE OWNER AND PERCENTAGE KAW LAND & CATTLE CO., INC.
COAL OWNER AND PERCENTAGE FCL
FEDERAL COAL LEASE FCL
BOUNDARIES OF AREA TO BE DISTURBED D
PRIME FARMLAND BOUNDARIES PF
TRAIL W/S
WATERSHED BOUNDARIES 1040
SECTION LINE 1055
PRE-MINE CONTOUR Z
ANTICIPATED POST-MINE CONTOUR T
COAL STRUCTURAL CONTOUR R/A
OVERBURDEN ISOPACH
COAL THICKNESS ISOPACH
COAL STRIKE AND DIP
COAL SUBCROP LIMIT
POWER LINES
TELEPHONE LINES OR CABLES
FENCES
REFERENCE AREA
BUFFER ZONE
ARCHAEOLOGICAL SITES
SURFACE WATER MONITORING POINT
SURFACE WATER SAMPLING POINT
EXISTING GROUND WATER MONITORING POINT
PROPOSED GROUND WATER MONITORING POINT
GROUND WATER SAMPLING POINT
EXPLORATORY DRILL HOLE LOCATION AND NUMBER
PERENNIAL STREAMS
INTERMITTENT STREAMS
EPHEMERAL STREAMS

- CONSTRUCTION NOTES**
- THERE SHALL BE NO BLASTING WITHIN 300 FEET OF ANY OCCUPIED DWELLING, PUBLIC BUILDING, SCHOOL, CHURCH, HOSPITAL, OR NURSING FACILITY, UNLESS THE NECESSARY APPROVALS ARE OBTAINED.
 - BUFFER ZONE = (1.5 X MINING DEPTH) + 25 FEET WILL BE ESTABLISHED ALONG THE BOUNDARY OF THE PROPERTY OWNED BY ADJOINING OWNERS ALONG THE HIGHWALL.
 - CONTACT OKIE DATA AT 1-800-522-6543 TO VERIFY THE LOCATIONS OF THE UTILITY LINES PRIOR TO ANY CONSTRUCTION ACTIVITIES.
 - PRIOR TO UTILIZING ASH DISPOSAL PIT NOS. 6 AND 7, BERM / CHANNEL NO. 6 SHOULD BE DIVERTED AWAY FROM ASH DISPOSAL PIT NOS. 6 AND 7.

		R 3 E					
PROJECT LOCATION		6	5	4	3	2	1
T	24	7	8	9	10	11	12
N		18	17	16	15	14	13
		19	20	21	22	23	24
		30	29	28	27	26	25
		31	32	33	34	35	36

MP-10

PREPARED BY: **EMERA CORPORATION**
P. O. BOX 2228, EDMOND, OK 73083

PREPARED FOR: **EVANS & ASSOCIATES CONSTRUCTION CO., INC.**
3320 NORTH 4TH STREET, PONCA CITY, OKLAHOMA 74602

TITLE OF MAP: **FINAL CLOSURE MAP**

DRAWN BY: CET SCALE: 1" = 100' DATE: 9-13-2017

DRAWING NO: MP-10 SHEET 11 OF 11 REVISED:

NAME OF PROJECT: **BIG FORK RANCH**

LOCATION: A PART OF SECTION 8, T24N, R3E, NOBLE CO., OKLAHOMA

CONTOUR INTERVAL: 1 - FOOT
DATE OF PHOTOGRAPHY & CONTOURS: JUNE 29, 2017

NOBLE COUNTY, OKLAHOMA

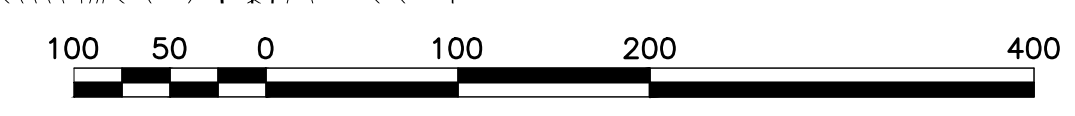

SCALE: 1" = 100'

PERMIT NO.: